

Ezy-Push[®] BS Lead Safe[™] Push Button Stop Cock - Cold

PRODUCT CODES:
- 172.61.43.09

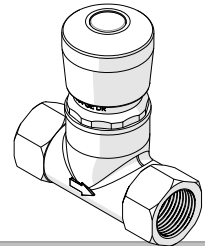

SPECIFICATIONS

- Vandal resistant push button design with constant flow, regardless of pressure.
- Easy to operate.
- Low maintenance.
- Galvin Engineering recommends the installation of strainers and pressure reducing valves to ensure clean consistent supply. Debris or poor water quality could cause the push button to seize or fail to seal.
- Lead Safe[™] brass construction.*

IMPORTANT: All Ezy-Push[®] Push Button taps are tested in accordance with AS/NZS 3718 and leave our premises in good working order.

*Our Lead Safe[™] product range is compliant with the Lead Free Requirements of the NCC 2022 Vol. Three, Clause A5G4(2) and NSF/ANSI 372.
**Any flow controller incorporated in the outlet to be tightened to prevent removal by hand. As Per AS3718.

WARNINGS: Special attentions to be paid on notes, photos, images, or drawings of assembly steps marked with the warning symbol.



TECHNICAL DATA

Inlet	G ½" - Female	
Outlet	G ½" - Female	
Headwork	Push Button	
Working Pressure Range (kPa)	Min	50
	Max	500
Working Temperature Range (°C)	Min	5
	Max	60
Finish	Brass	

NOTE: Galvin Engineering continually strive to improve their products. Specifications may change without notice.

TOOLS REQUIRED

- Spanner
- Thread tape

PRE-INSTALLATION - MOUNTING DETAILS

! *Note: Before installation, all lines must be flushed. We recommend that a line strainer be installed prior to drinking taps to eliminate any foreign material.*

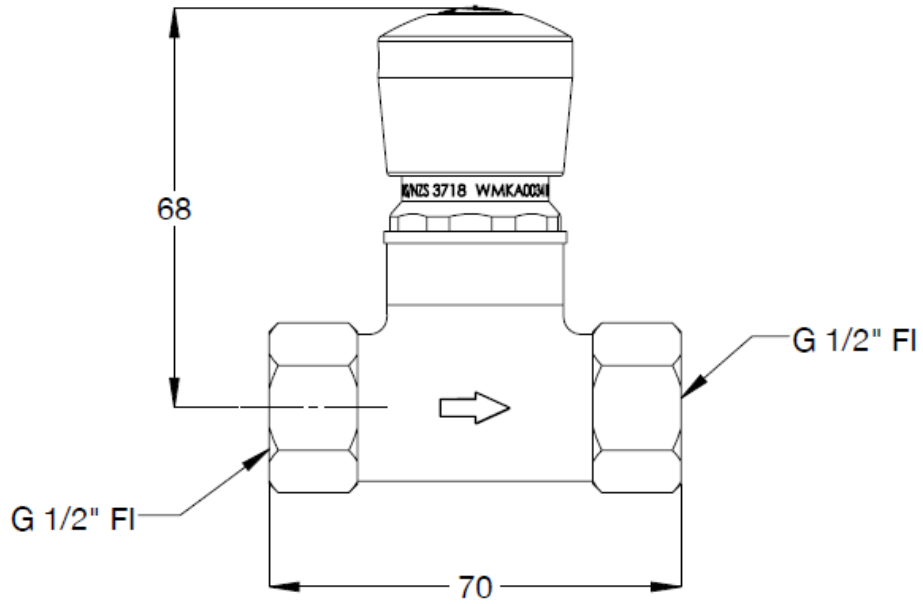

INSTALLATION

INSTALLATION COMPLIANCE: Galvin Engineering products must be installed in accordance with these installation instructions and in accordance with AS/NZS 3500, the PCA and your local regulatory requirements. Water and/or electrical supply conditions must also comply to the applicable national and/or state standards. Failing to comply with these provisions shall void the product warranty and may affect the performance of the product.

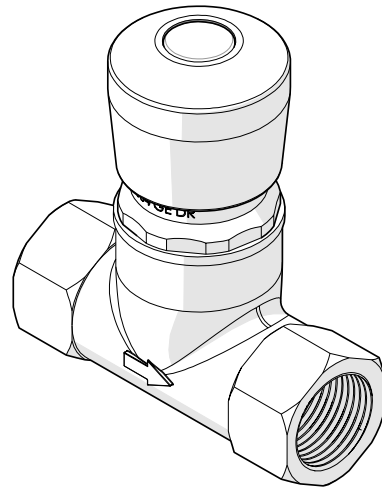
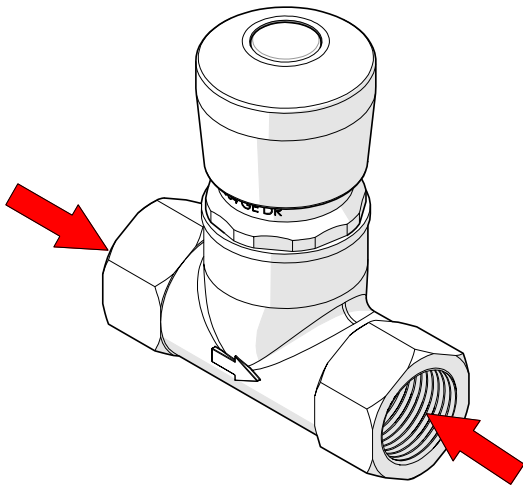

1. Connect the body to water line

- Connect the water on both ends. Flow restrictors must be fitted prior to the valve bodies to enable the flow rate to be at the recommended level.

Note: Never operate without flow restrictors, as Ezy-Push® Push Button Tapware will deliver full mains pressure with unrestricted flow

2. Testing

- Once connected turn on the water and check for any leaks and that it is operating correctly.

TROUBLESHOOTING

PROBLEM	CAUSE	RECTIFICATION
Inconsistent flow	Blocked top assembly	Remove top assembly and clean
Water is not flowing from tap	Water is turned off	Turn on water
	Blocked flow restrictor	Remove restrictor and clean
Continuous flow	Top assembly cartridge loose or internally obstructed or damaged	Remove cartridge, clean with water and re-grease spindle if required
Button hard to press	The mains pressure may be too great	Reduce to below 500kPa (70PSI). Regrease spindle if required

WARRANTY

Galvin Engineering products are covered under our Manufacturer's Warranty. Galvin Engineering products must be installed in accordance with the installation instructions and in accordance with AS 3500 and NCC Volume Three, relevant Australian Standards and local authorities applicable to product being installed. Water and electrical supply conditions must also comply to the applicable national and/or state standards, failing to comply with these provisions may void the product warranty and affect performance of the product.

Please visit www.galvinengineering.com.au to view the full warranty, our Installation Compliance and Maintenance & Cleaning information as well as any other additional information.